

# *Rohnson*<sup>®</sup>

INSTRUCTION MANUAL

**COFFEE MAKER R-950**



**Read this manual thoroughly before using and save it for future reference.**

# IMPORTANT SAFEGUARDS

When using electrical appliance, basic safety precautions should always be followed including the following:

1. Read all instructions.
2. Make sure that your outlet voltage corresponds to the voltage stated on the rating label of the coffee maker.
3. To protect against fire, electric shock and injury to persons do not immerse cord, plug, or in water or other liquid.
4. Close supervision is necessary when any appliance is used by or near children.
5. Unplug from outlet when not in use and before cleaning. Allow to cool before putting on or taking off parts, and before cleaning the appliance.
6. Do not operate any appliance with a damaged cord or plug or after the appliance malfunctions or has been damaged in any manner. Return appliance to an authorized service facility for examination, repair, or adjustment.
7. The use of accessory not recommended by the appliance manufacturer may result in fire, electric shock, or injury to persons.
8. Do not use outdoors.
9. Do not let cord hang over edge of table or counter or touch hot surface.
10. Do not place on or near a hot gas or electric burner, or in a heated oven.
11. Do not use appliance for other than intended use.
12. Do not clean carafe with cleansers, steel wool pads, or other abrasive material.
13. To disconnect, turn any control to "Off", remove plug from wall outlet. Always hold the plug. But never pull the cord.
14. Scalding may occur if the cover is removed during the brewing cycles. Be careful not to get burned by the steam.
15. Some parts of appliance are hot when operated, so do not touch with hand. Use handles or knobs only.
16. Do not set a hot carafe on a hot or cold surface.
17. Do not let the coffee maker operate without water.
18. Do not use a cracked carafe or a carafe having a loose or weakened handle.
19. Make sure the carafe is placed on the warming plate correctly during the brewing.
20. To reduce the risk of fire or electrical shock, do not remove the bottom cover. No user serviceable parts

inside. Repair should be done by authorized service personnel only.

21. The carafe is designed for use with this appliance. It must never be used on a range top.

22. This appliance can be used by children aged from 8 years and above and persons with reduced physical, sensory, or mental capabilities or lack of experience and knowledge if they have been given supervision or instruction concerning use of the appliance in a safe way and understand the hazards involved. Children shall not play with the appliance. Cleaning and user maintenance shall not be made by children without supervision.

23. Children should be supervised to ensure that they do not play with the appliance.

24. This appliance is intended to be used in household and similar applications such as:

- staff kitchen areas in shops, offices and other working environments;
- farm houses;
- by clients in hotels, motels and other residential type environments;
- bed and breakfast type environments.

25. Save these instructions.

# KNOW YOUR COFFEE MAKER

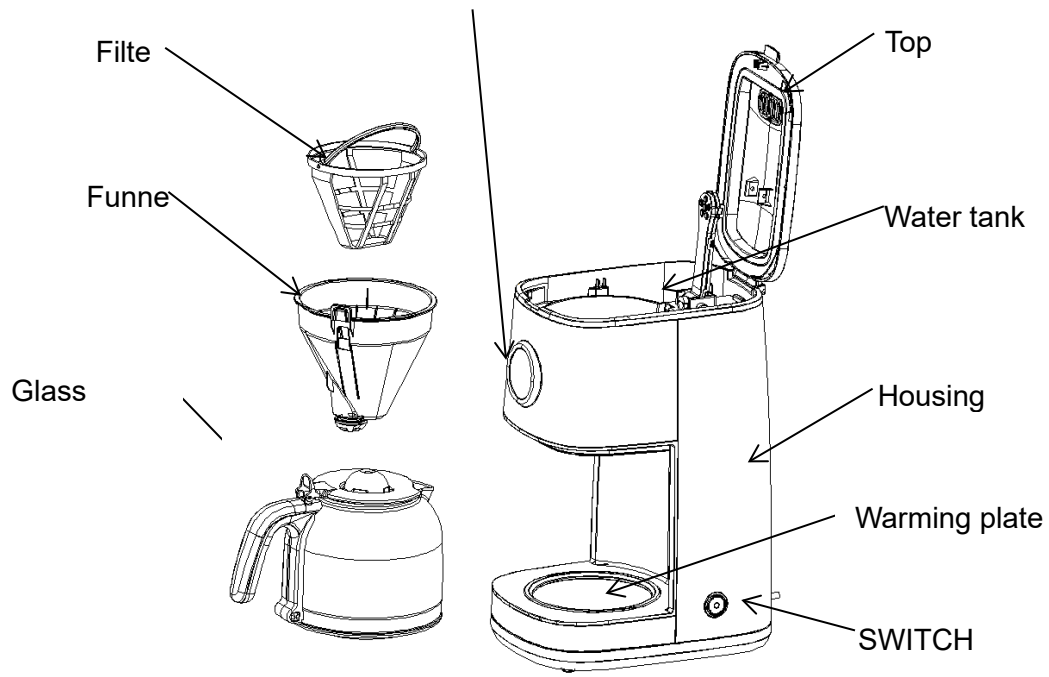

Clock & Switch



## **BEFORE THE FIRST USE**

Check that all accessories are complete, and the unit is not damaged. Fill water into water tank to the “12” level and brew water for several times without coffee powder, then discard the water. Clean and dry all detachable parts thoroughly according to the section “CLEANING AND MAINTENANCE”.

## **USING YOUR COFFEE MAKER**

1. Open the top cover and fill the water tank with drinking water. The water level should not exceed “12” level as indicated on the water level gauge.

2. Place the funnel into the funnel support of coffee maker, make sure it is fit correctly, otherwise the top cover cannot be closed in place appropriately. Place a filter or filter paper into the funnel.

3. Add coffee powder into the filter. Usually, a cup of coffee needs a level spoon of coffee powder, but you may adjust according to personal taste. Close the top cover completely.

4. Insert the glass carafe with lid closed onto the warming plate horizontally.

5. Press “ON/OFF” button once, the ON/OFF indicator illuminates in blue, and the coffee maker starts to brew regular coffee.

6. The brewing process can be interrupted by pressing ON/OFF button again anytime, and the ON/OFF indicator will extinguish, indicating your coffee maker is shut off.

Note: You can take out carafe, pour and serve at any time. The appliance will stop dripping automatically. But the time cannot exceed 30 seconds.

8. Remove out the carafe to serve when finish brewing (about one minute later after the coffee stops dripping out.)

Note: The coffee you get will less than the water you have added, as some water is absorbed by coffee ground and adhere to the plastic.

9. When finish brewing, keep the coffee maker be energized if you do not want to serve immediately, the coffee can be kept warm on the warming plate, and the coffee maker will shut off automatically after 40 minutes from the end of brewing process if it has not been manually disconnected at the completion of brewing. For an optimum coffee taste, serve it just after brewing.

10. Always turn the coffee maker off and disconnect the power supply when not use.

Note: Pay attention to pour the coffee out, otherwise you may be hurt as the temperature of coffee just finished is high.

## **CLEANING AND MAINTENANCE**

**CAUTION:** Be sure to unplug this appliance before cleaning. To protect against electrical shock, do not immerse cord, plug or unit in water or liquid. After each use, always make sure plug is first removed from wall outlet.

1. Clean all detachable parts after each use in hot sudsy water.
2. Wipe the exterior surface of unit with a soft, damp cloth to remove stains.
3. Water droplets may buildup in the above area of the funnel and drip onto the product base during brewing. To control the dripping, wipe off the area with a clean, dry cloth after each use.
4. Use a damp cloth to gently wipe the warming plate. Never use abrasive cleaner to clean it.
5. Replace all parts and keep for next use.

## **REMOVING MINERAL DEPOSITS**

To keep your coffee maker operating efficiently, periodically you should clean away the mineral deposits left by the water according to the water quality in your area and the use frequency, we recommend removing mineral deposits as follows:

1. Fill the water tank with water and descaler to the max level as indicated on the water level gauge (the scale of water and descaler is 4:1, the detail refers to the instruction of descaler. Please use "household descaler", you may also use the citric acid instead of the descaler (the one hundred parts of water and three parts of citric acid).
2. Insert the glass carafe onto the warming plate.
3. Make ensure filter (without coffee powder) and funnel are assembled in place.
4. Turn on the appliance and allow it to "brew" de-scaling solution by following the operation above.
5. After "brew" one-cup solution, switch off the appliance.
6. Leave the solution stay for 15 minutes and repeat step 3-5.
7. Turn on the appliance and run off the solution until the water tank is completely empty.
8. Rinse by operating the appliance with water at least 3 times.

## HINTS FOR GREAT-TASTING COFFEE

1. A clean coffee maker is essential for making great-tasting coffee. Regularly clean the coffee maker as specified in the “CLEANING AND MAINTENANCE” section. Always use fresh, cold water in the coffee maker.
2. Store unused coffee powder in a cool, dry place. After opening a package of coffee powder, reseal it tightly and store it in a refrigerator to maintain its freshness.
3. For an optimum coffee taste, buy whole coffee beans and finely grind them just before brewing.
4. Do not reuse coffee powder since this will greatly reduce the coffee’ flavor. Reheating coffee is not recommended as coffee is at its peak flavor immediately after brewing.
5. Clean the coffee maker when over-extraction causes oiliness. Small oil droplets on the surface of brewed, black coffee are due to the extraction of oil from the coffee powder.
6. Oiliness may occur more frequently if heavily roasted coffees are used.



### **IMPORTANT INFORMATION FOR CORRECT DISPOSAL OF THE PRODUCT IN ACCORDANCE WITH EC DIRECTIVE 2012/19/EU.**

At the end of its working life, the product must not be disposed of as urban waste. It must be taken to a special local authority differentiated waste collection center or to a dealer providing this service. Disposing of a household appliance separately avoids possible negative consequences for the environment and health, deriving from inappropriate disposal and enables the constituent materials to be recovered to obtain significant savings in energy and resources. As a reminder of the need to dispose of household appliances separately, the product is marked with a crossed-out wheeled dustbin.