

# Rohnson®

**Stand fan with DC motor & remote control**  
**Model: R-8650**  
**Instruction Manual**



\*\* Scan with your phone or QR reader to find out more about your machine

Read this Instruction Manual carefully before assembling or operating the appliance and keep it for future reference.

## Safety Warnings and Precautions

1. This product is for indoor use only.
2. Only use a qualified power outlet that has been checked and meets the requirements. Please confirm the voltage when the device is relocated.
3. This appliance is not intended for use by persons (including children) with reduced physical, sensory or mental capabilities, or lack of experience and knowledge, unless they have been given supervision concerning use of the appliance by a person responsible for their safety. Children should be supervised to ensure that they do not play with the appliance.
4. This appliance can be used by children aged from 8 years and above and persons with reduced physical, sensory or mental capabilities or lack of experience and knowledge if they have been given supervision concerning use of the appliance in a safe way and understand the hazards involved. Cleaning and maintenance shall not be made by children unless they are supervised by a person responsible for their safety.
5. If the power cord is damaged, it must be replaced by the manufacturer, its service agent or similarly qualified persons in order to avoid a hazard.
6. Please turn off and unplug the appliance before cleaning or maintenance.
7. Do not use the fan in the following special environments:
  - Humid places (bathroom, basement, etc.);
  - Places susceptible to sun and rain;

- Places where corrosive and explosive gases (dust, steam) exist;
  - Environment with extreme temperature exceeding the use limit.
8. Do not insert any objects into the front and back grille during use to in order avoid safety accidents.
  9. Do not let children touch the fan.
  10. Avoid external impact on the fan and do not operate with excessive force.
  11. Cut off the power supply and unplug the power cord when it is not in use for a long time.
  12. Do not ingest battery, Chemical Burn Hazard;
  13. This product contains a coin / button cell battery. If the coin / button cell battery is swallowed, it can cause severe internal burns in just 2 hours and can lead to death;
  14. Keep new and used batteries away from children.
  15. If the battery compartment does not close securely, stop using the product and keep it away from children.
  16. If you think batteries might have been swallowed or placed inside any part of the body, seek immediate medical attention.
  17. The batteries contain materials, which are hazardous to the environment; they must be removed from the appliance before it is scrapped and that they are disposed of safely.

## Functions and Names of Parts

- Schematic diagram of product structure

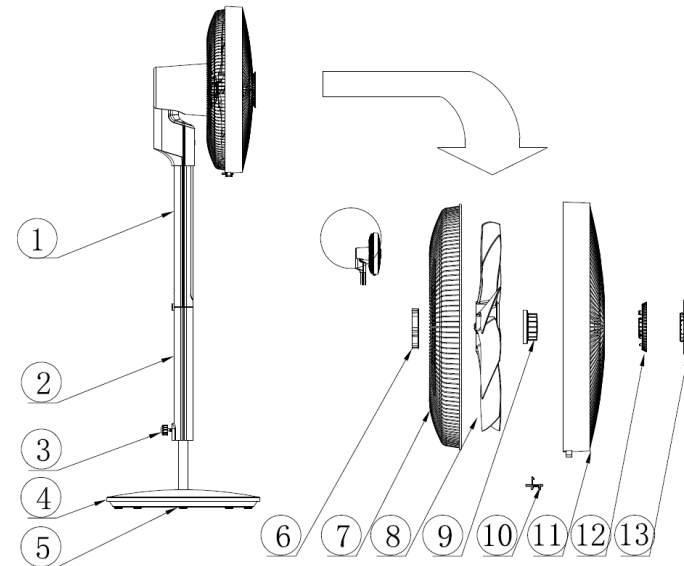

1. Main body; 2. Post assembly; 3. Winged screw; 4. Chassis assembly; 5. Chassis bolt; 6. Grille restraint; 7. Rear grille; 8. Wind blade; 9. Blade restraint; 10. Guard ring lock; 11. Front grille; 12. Incense box; 13. Incense box cover.

## Accessories



Remote control

## Main unit display panel



## Main unit key panel

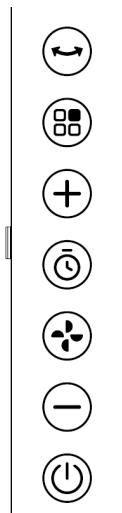

## Product Installation and Use

### ● Installation method

1. Open the package and take out the product: Check whether the manual, remote control, and other accessories are complete.
2. Assemble the fan as shown in the figure below. The installation method is as follows.

- ① Insert the bottom of the post tube assembly into the hole of the base, and then use the chassis bolt to lock the post tube (Fig. 1)
- ② Sleeve the main body into the top of the post tube assembly until the buckle is effectively buckled in (Fig. 2)
- ③ Put the rear grille on the front cover of the motor, align the two reference columns with the positioning holes of the net grille, screw in and fix it with the grille restraint (Fig. 3)
- ④ Insert the fan blade into the motor shaft and screw it in counterclockwise with the blade restraint (Fig. 4)
- ⑤ Gradually buckle the front grille assembly onto the rear grille, buckle the rear grille locking device, and screw in the fixing screws to fix the grille cover (Fig. 5)
- ⑥ After the fan is assembled, put it upright, turn on the power and operate according to the instructions.

Fig. 1

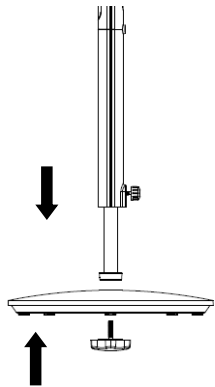

Fig. 3

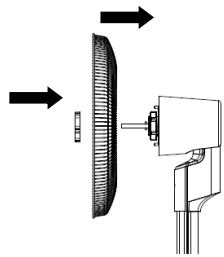

Fig. 5

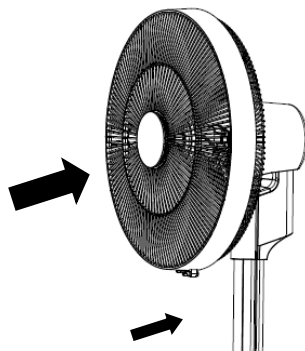

Fig. 2

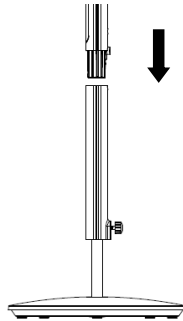
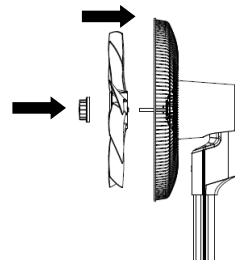

Fig. 4



- How to use each function button

The buttons are touch buttons. Touch the buttons on the operation panel to trigger the corresponding functions.

**1. Power on/off button**  :

A. In standby state, press this button to make the fan run in the mode memorized last time (sleep mode and timer are not saved). If it is turned on for the first time, it will run in the default mode, namely level 10, normal wind, no swing, no timer, the indicator lights up, and the digital tube displays the current wind speed.

B. In working state, press this button to shut down, the buzzer beeps, the fan stops rotating, and the system returns to the standby state without any output or display.

**2. Left/right swing button**  :

In power-on state, press this button to turn on or off the left/right swing. Press it repeatedly to switch among 30°→90°→180°→320°→off, and the left/right swing angle indicator lights show its function correspondingly.

**3. Wind speed button**  :

In power-on state (in timer setting mode), press the wind speed button to switch to the wind speed level adjustment state, and use the +/- button to adjust the value. (1↔2↔3↔4↔5↔...↔31↔32) The digital tube displays the current level position, and the wind speed indicator light is on.

2) In power-on state (not in timer setting mode), you do not need to press the wind speed button. Simply use the +/- button to adjust the value. (1↔2↔3↔4↔5↔...↔31↔32) The digital tube displays the current level position, and the wind speed indicator light is on.

#### 4. +/- button

1) The wind speed level can be adjusted when it is not in the timer setting mode. At this moment, use the +/- button to adjust the value. (1↔2↔3↔4↔5↔...↔31↔32) The digital tube displays the current level position, and the wind speed indicator light is on.

2) In timer setting mode, press the +/- button to increase/decrease the value of schedule shutdown/start time. (1↔2↔3↔4↔5↔...↔12) The digital tube displays the current set time, and the "H" indicator light is on.

3) In wind speed/timer setting state, press and hold the +/- button for 3 seconds to enter the quick adjustment mode of speed level (no buzzer sound). The buzzer beeps when the + button is released.

#### 5. Wind mode button

A. When the fan is turned on for the first time, it runs in normal wind mode. You can press the wind mode button to switch the wind mode in the following sequence: normal → natural → sleep → normal..... When running in normal wind, no indicator light is on, while in other modes, the corresponding indicator shows its function.

B. Normal wind: The product operates in accordance with the wind speed (32 levels) set by the user and runs at a fixed speed.

C. Natural wind: This mode imitates the blowing effect of nature wind, making the wind softer and more comfortable. In this mode, different wind levels will have different wind speed modes. The 32 levels are divided into three groups. The specific design is as follows:

① When switching to natural wind from level 1~10 normal wind, it is low level natural wind, and digital tube displays level 10;

② When switching to natural wind from level 11~20 normal wind, it is medium level natural wind, and digital tube displays level 20;

③ When switching to natural wind from level 21~30 normal wind, it is high level natural wind, and digital tube displays level 32;

In this mode, the wind speed button can only be low, medium or high level natural wind. The specific waveforms of natural wind mode are as follows:

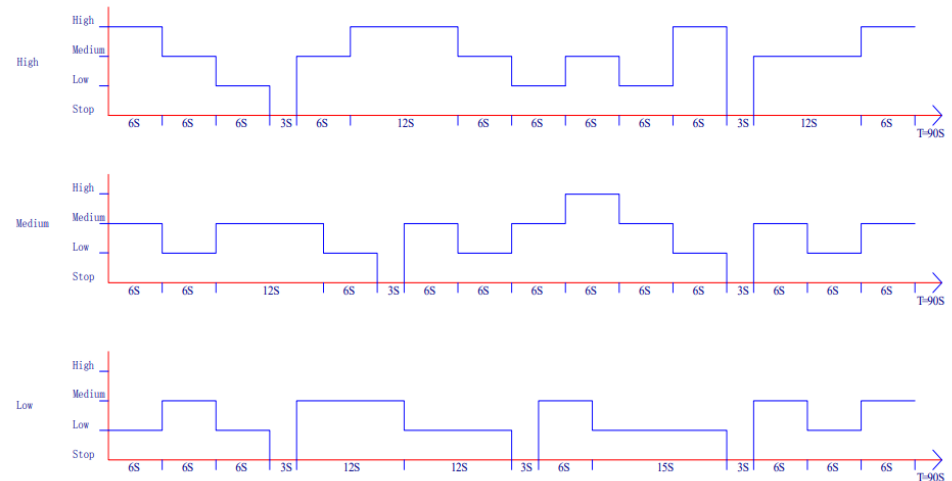

High level natural wind

Medium level natural wind

Low level natural wind

D. The operation law of sleep wind is described as follows:

Sleep wind: Downshift regularly according to the rules preset by the program at the wind speed set by the user

High speed: 30 minutes level 32 normal wind → 30 minutes level 20 normal wind → level 10 normal wind until shutdown.

Medium speed: 30 minutes level 20 normal wind → level 10 normal wind until shutdown.

Low speed: Normal wind operation at level 10 until shutdown. 6. Memory function

In power-on state, the wind level, swing and other functions are all memorized (except timer and sleep wind mode)

If there is no button action after any indicator light is on for 1 minute, the indicator light will be dimmed (33% of the original brightness). If any button is actuated again, the indicator light will become brighter.

## 6. Timer button :

a. Press the timer button in power-on state to enter the timer setting state. The time indicator “H” is on, and the digital tube flashes at an interval of 0.5 second. The default value is 1, and the prefix 0 is not displayed. At this moment, use the +/- button to adjust the value (1↔2↔3↔4↔5↔...↔12), press any other button (except ON/OFF and timer) or wait for 5 seconds to complete the timer setting successfully. When the timer is set and the countdown ends, the fan immediately enters the standby state without any sound.

b. In standby state, press the timer button to reserve working time of the fan. The time indicator “H” lights up, and the digital tube flashes at an interval of 0.5 second. The default value is 1, and the prefix 0 is not displayed. At this moment, use the +/- button to adjust the value. After confirming the time, wait for 5 seconds to set the reservation time successfully. After making a reservation, the digital tube displays the reserved time, and the time indicator lights up. When the internal timer program reaches the set time, the fan will turn on and run in the state before shutdown (sleep wind and timer are not memorized).

## Use of remote control:

1. First open the battery cover on the back of the remote control and install a 3V CR2032 battery before it can be used.

2. When using, please aim at the position of the receiver. When infrared rays are blocked by any object, the remote control is invalid. Please keep the remote control properly. Do not drop it to the ground. It can be placed in the handle of the back shell for easy access.
3. When the battery is exhausted, pull out the battery cover in the direction shown in the figure, and then replace the battery with a new one. When replacing a new battery, pay attention to the polarity of the battery, and put back the battery cover properly.

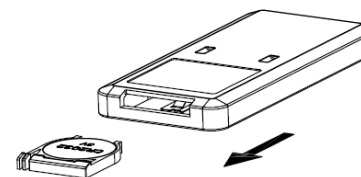

## Cleaning and Maintenance

Before cleaning and maintenance, unplug the power cord.

- If there is too much foreign matter or dust attached to the air outlet of the front grille and fan blades, it will affect the air outlet effect, so it is recommended to clean at least once every other month.

1. Turn off the power and unplug the power plug (be sure to unplug the power cord before cleaning the body, or else there may be electric shock or mechanical damage).
2. For cleaning, use ordinary detergent and soft brush. Do not use chemical agents.

- Body surface cleaning

1. To clean the surface, wipe it with a damp cloth. It is strictly forbidden to rinse with water directly.
2. Do not use corrosive detergents or solvents for cleaning.
3. Be sure to turn off the power and unplug the power cord before cleaning, or else there is a possibility of electric shock.

- Product storage:

1. When the product is not used for a long time, pull out the power plug and pack the main unit to prevent dust from entering.
2. Store the fan in a dry and ventilated place after packaging.

### Service Guide

When the fan does not rotate, has peculiar smell or other exceptions, you should immediately cut off the power supply and notify the after-sales service center for repair.

### Technical Parameters

Model	R-8650
Rated parameters	Adapter: Input: 100-240VAC 50/60Hz; Output: DC24V 1.5A Overall: DC24V, 33W, class II
Rated power	33W
Noise	≤50 dB
Standby power consumption	≤0.5W
Size (length × width × height)	Standing type: 416mm×255mm×1150-1250mm (height adjustable)



### IMPORTANT INFORMATION FOR CORRECT DISPOSAL OF THE PRODUCT IN ACCORDANCE WITH EC DIRECTIVE 2002/96/EC.

At the end of its working life, the product must not be disposed of as urban waste. It must be taken to a special local authority differentiated waste collection centre or to a dealer providing this service. Disposing of a household appliance separately avoids possible negative consequences for the environment and health, deriving from inappropriate disposal and enables the constituent materials to be recovered to obtain significant savings in energy and resources. As a reminder of the need to dispose of household appliances separately, the product is marked with a crossed-out wheeled dustbin.